

# Air Purifier

with 4-Stage Filtration

Model: MOR-AP02

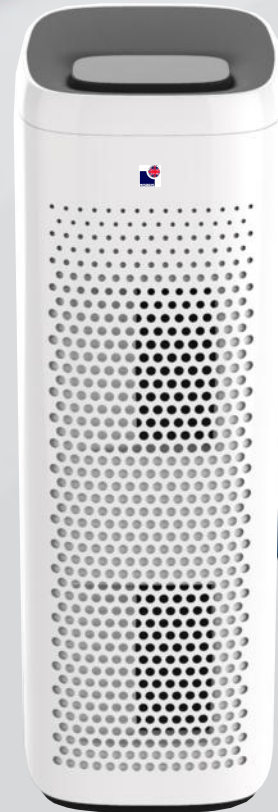

hepa  
13

Important  
safety  
instructions

**READ AND SAVE THESE SAFETY INSTRUCTIONS  
BEFORE USING THIS AIR PURIFIER**

## **Table of contents**

Safety Instructions	3
Product Specification	4
Get to Know Your Appliance	5
Need to know before use	6
Operating the MOR-AP02	7
Cleaning & Maintenance	8
Troubleshooting	10

# Safety Instructions

- Safety precautions should always be used when operating this or any electrical appliance. Decrease the risk of electrocution, electric shock, injury or fire by reading and following all the warnings below.
- Use only as described in this MOR-AP02 manual. To reduce the risk of electric shock, do not attempt to service the product in any way other than in the manner described in the “Cleaning & Maintenance” section of this manual.
- This product operates at 220-240V, 50/60Hz only.
- Do not run cord under carpeting. Do not cover the cord with throw rugs, runners, or similar coverings. Arrange the cord away from the traffic area so that it will not be tripped over.
- Always unplug the power cord from the electrical outlet when the purifier is not in use, before cleaning, inserting or removing parts, or moving to another location.
- Failure to follow the maintenance instructions in the product manual may void the after-sales guarantee for a one-year warranty and may result in serious personal injury or damage to the machine.
- Do not use the air purifier in bathrooms or other humid environments. Do not use near fireplaces or areas where flammable or combustible vapours or products may exist.
- Always remove the plug from its power outlet by holding onto the plug itself and pulling gently.
- Never run the air purifier unless it is fully assembled.
- Children should operate this product under adult supervision.
- Always turn off all controls before unplugging the air purifier from the outlet.
- Never touch the air purifier or its plug when your hands are wet.
- Do not place the cord near a heated surface. If the supply cord is damaged, it must be replaced by the manufacturer, its service agent or similarly qualified persons in order to avoid a hazard.
- Do not operate the product in any greasy environment, such as in the kitchen. This product is not intended to filter oil or grease from the air.
- Never use the power cord to pick up, carry, drag, pull, or lift the air purifier. Do not pull the cord against or around sharp corners and edges. This could result in injury to the user or damage to the cord.
- Never pull on the cord itself to unplug it from its power outlet.
- Use care when operating the air purifier by keeping all foreign objects, fingers, body parts, hair, loose clothing and jewellery away from the air inlet.

# Product Specification

Model number	MOR-AP01
4-Stage Filtration	<b>Pre-filter</b> removes large particles. <b>HEPA filter (H13)</b> captures particles as small as 0.3 microns. <b>Activated carbon filter</b> neutralizes unpleasant odors. <b>Ionizer booster</b> releases negative ions that binds to and neutralises airborne pollutants for a cleaner environment
Wattage	66w
Soud Level	39-54DB
Area Coverage	12-22m2
CADR Rate	200m3/h
Size	L240 W178 H512
Fan speeds	3
Sleep Mode	Yes
Night Light	Yes
Filter change reminder	Yes
UV Light	Eliminates Germs, Bacteria link to Covid
Negative Ions	Yes
Auto Mode	No
Electronic control	Yes
PM	3.00
Timer	2,4,8 hours
Twin Fan	Yes

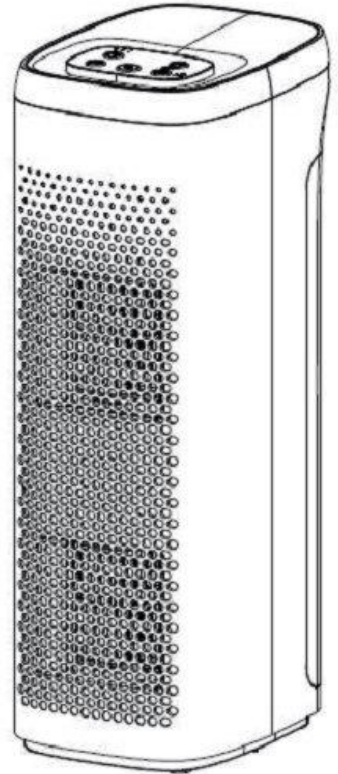

# Get to Know Your Appliance

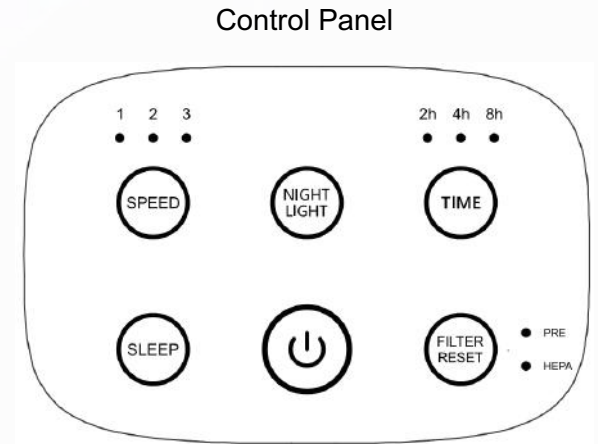
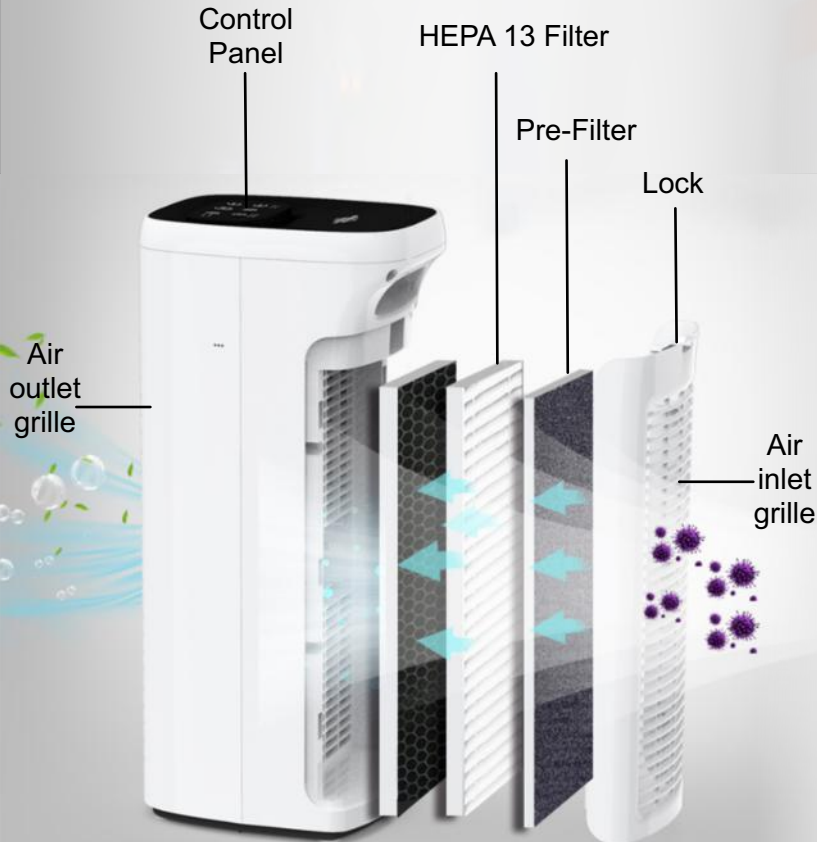

# Need to know before use



Please keep the product away from the fan to avoid affecting the normal operation of the product;



Do not place the product near the curtains to prevent to avoid the curtain from being sucked in and therefore damaging the product.

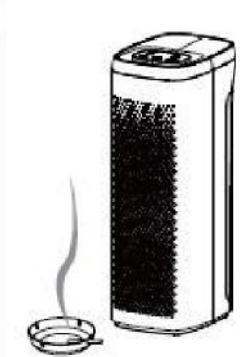

Please put the product in the polluted air area to effectively improve indoor air quality.

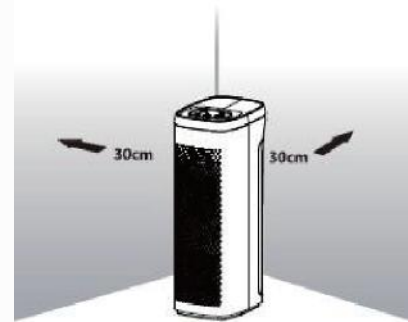

Place the product horizontally when using it and ensure that the machine is at least 30 cm away from the wall to ensure normal running.

Notice: Check the filter before using it. Do not use this product if the filter is damaged. Please replace a new filter if there are cracks or holes in the filter.

# Operating the MOR-AP02

## **On/Off Button**

Press the power button to switch on the appliance.

## **Fan Speed Adjustment**

In the power-on state, press the “SPEED” button to adjust the fan speed. Press the wind speed button continuously (delay 0.5 seconds between each gear position), and the wind speed of the machine will be switched from 1 to 3.

## **Sleep Mode**

In the power-on state, press the “SLEEP” button and the machine will enter in sleep mode: the machine will run at Speed 1, and other indicators will be turned off except the power light; press it again and the machine will exit from the Sleep Mode.

## **Night Light**

When the machine is on, press the "Night Light" button, and the night light (blue LIGHT) is on. Press again to turn off the NIGHT LIGHT. When the nightlight function is turned on, the key light and indicator light on the panel will become half bright.

## **Timing**

Under the power-on state, press the timing button, and the timing function will turn on, and the timing icon and indicator light will light up, and press 2H-4H-8H-to close the display cycle.

## **Filter Replacement Indicator**

When the cumulative working time of the machine reaches 1500 hours, the pre-filter indicator light will be lit up (red) to remind you to replace the filter; when the cumulative working time of the machine reaches 3000 hours, the HEPA filter indicator light will be lit up(red) to remind you to replace the filter.

When only the PRE filter indicator light is on, press the FILTER RESET button for 3 seconds to turn off the PRE indicator light and clear PRE filter screen timing; when only the HEPA filter indicator light is on, press the FILTER RESET button for 3 seconds to turn off the HEPA indicator light and clear HEPA filter timing; when both filter indicator lights are on, press FILTER RESET button for long. In 3 seconds, two filter indicators can be switched off, and two filters' timing will be cleared.

# Cleaning & Maintenance

Warning: Before cleaning and maintaining this product, be sure to turn off the power and unplug it from the power source to avoid electric shock.

## How to replace the HEPA filter

1. Pull the air inlet grille out (see the picture).
2. As shown in the figure, the air inlet grille has been opened.
3. Grab the frame on both sides of the HEPA filter and remove the filter from the product.
4. Replace the unused HEPA filter with the reverse operation as shown below.

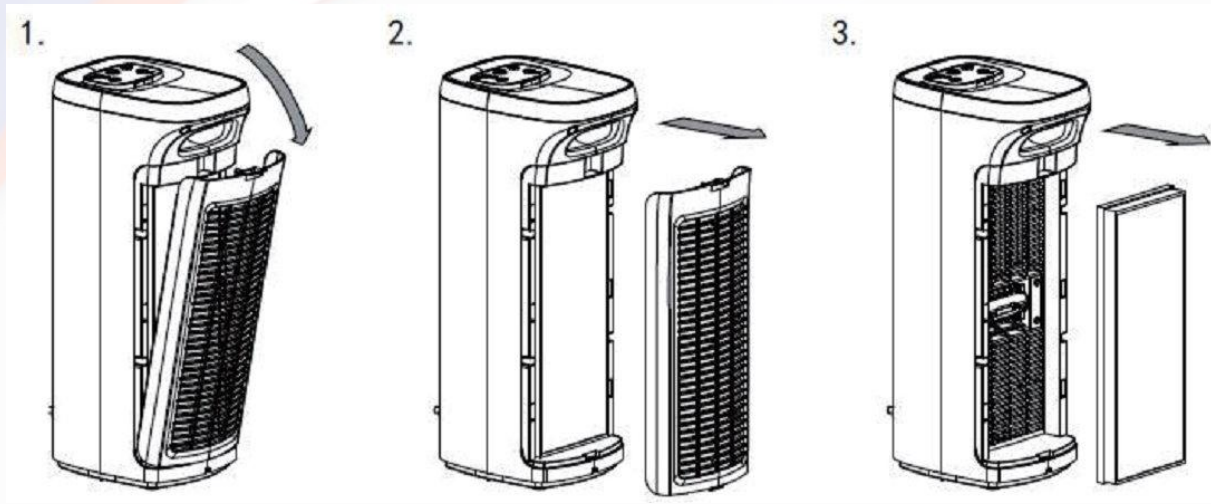



## **Pre-filter Maintenance**

The preliminary filter can be cleaned with water. It is not recommended to use the air purifier in places full of candles, soot, fireplace soot, or smoke. If used in such an environment, the filter should be cleaned frequently.

## **Attention**

- Please carefully identify the front and rear direction of the filter assembly to avoid the wrong installation.
- It is recommended to wear gloves when replacing the filter. And to prevent secondary pollution in the old filter components, please put the old filter components in plastic bags before discarding them to prevent secondary pollution to the environment.
- 

## **Outer Surface Cleaning**

1. Turn off the power and unplug
2. Clean the surface of the machine casing with a towel and a little soapy water.
3. Do not allow water to flow into the machine, as this may damage your machine and cause electric shock and damage to you.
4. After cleaning, please put the product in a ventilated place (not exposed), until the machine is completely dry before turning it on.

# Troubleshooting

Common problem	Possible cause	Solutions
The machine doesn't work	<ol style="list-style-type: none"><li>1. The power switch is not turned on</li><li>2. Unplugged</li></ol>	<ol style="list-style-type: none"><li>1. Press the power on button to turn it on</li></ol>
Airflow reduced or purification effect is unsatisfied	<ol style="list-style-type: none"><li>1. Air inlet or air outlet is blocked</li><li>2. Pre filter may be blocked</li><li>3. Filter life expires</li></ol>	<ol style="list-style-type: none"><li>1. Check and make sure the air inlet and outlet are not blocked</li><li>2. Check and clean the filter if necessary</li><li>3. Replace the filter</li></ol>
The filter indicator blinks all the time	<ol style="list-style-type: none"><li>1. Filter life expires</li><li>2. Filter is not reset after replacing the filter</li></ol>	<ol style="list-style-type: none"><li>1. Replace the filter</li><li>2. Reset filter setting</li></ol>

## We're here to help

 [morrisdirect.co.uk](http://morrisdirect.co.uk)

 01562 261026

 Unit 4a, Thornleigh Trading Estate  
Dudley, West Midlands, DY2 8UB



Do the Earth a Favour

**BE A POWER SAVER**